

Product guide

# Osma Compact

Commercial Soil and Waste



# Contents

## Osma Compact



<b>Introduction</b>	<b>2</b>	<b>Estimating Data</b>	<b>7</b>	<b>Overflow</b>	<b>50-53</b>
Osma PVC-U Compact Soil System	2	Estimating Data	7	<b>Design Information</b>	<b>54</b>
		Jointing Material Allowances	7	Typical Bathroom Installation	54
<b>Systems Overview</b>	<b>3-6</b>	<b>Product Selector</b>	<b>8-53</b>	Elevation	54
Osma PVC-U Compact Soil System	3	Introduction to Product Selector	8	Plan	54
Boss Adaptors	4	<b>Solvent Soil</b>	<b>9-22</b>	<b>Transport, Handling and Storage</b>	<b>55</b>
Branches	4	<b>Ring-Seal Soil</b>	<b>23-29</b>	Handling, Storage and Safety	55
Osma WC Connectors	5	<b>Solvent Waste</b>	<b>30-33</b>	<b>General Information</b>	<b>56-58</b>
Osma PVC-C Solvent Weld Waste System	5	<b>Accessories</b>	<b>34-43</b>		
Osma Water Seal Traps	6	<b>Traps</b>	<b>44-49</b>		
Osma Condensate Drainage	6				
Osma Solvent Weld Overflow System	6				

# Introduction

# Osma Compact

## Osma PVC-U Compact Soil System

The Osma PVC-U Compact Soil system enables space saving and flexible installations for efficient removal of waste water. Reduced installed dimensions minimise duct space required, providing the ideal solution for multi-occupancy and flat developments, where space is a premium.

### Features and Benefits

#### Space Saving

- ④ Compact Soil units allow greater design flexibility with tighter connections to 32, 40 and 50mm waste pipework
- ④ The reduced dimensions help minimise the duct space required

#### Ease of Installation

- ④ Branches available with rotating bases: enables connections in difficult-to-reach spaces
- ④ Innovative 'stop' position on fitting to prevent waste being installed with a fall less than 2.5°
- ④ Solvent weld and push-fit connection options

### Sustainability

110mm and 160mm pipes are manufactured utilising Wavin's Recycore® Technology.



### Complimentary Ranges

To compliment the Osma PVC-U Compact Soil, we also have Osma PVC-C Solvent Weld Waste, WC Connectors, Traps, Condensate and Overflow ranges (covered in this product guide).

For Wavin AS Acoustic Soil System or Wavin HDPE, see separate product guides or our Wavin Commercial Above Ground Product Guide.

### Applications

For vertical soil stacks and horizontal WC pipe in buildings where space is at a premium:

- ④ Apartment buildings
- ④ Hotels
- ④ Warehouses
- ④ Retail developments
- ④ Halls of residence
- ④ Hospitals
- ④ Offices





# Systems Overview

## Osma Compact

### Osma PVC-U Compact Soil System

- Osma PVC-U Compact Soil System is specifically designed to minimise installed space requirement
- Solvent weld and push-fit fittings take up less room and offer unrivalled flexibility in installation
- Large selection of single, double and unequal branches with new boss configurations
- Available in 82, 110 and 160mm diameters
- Colour: 82mm Grey / 110/160mm Olive
- 82/110/160mm fittings and 82mm pipe in PVC-U to BS EN 1329-1:2000
- 110 /160mm pipe is manufactured with Wavin Recycore technology – a multi-layer construction with over 50% recycled material in solid core
- 110 /160mm pipe sizes are BS EN 1453-1:2000 kitemarked but have exactly the same performance characteristics as BS EN 1329-1:2000



Table 1: PVC-U Soil system: Pipe Dimensions (mm) and Weights (kg/m)

Nominal Size (mm)	Outside Diameter		Wall Thickness		Average Weight (kg/m)
	Min	Max	Min	Max	
82	82.4	82.8	3.3	3.5	1.22
110	110.0	110.3	3.2	3.5	1.64
160	160.0	160.4	3.2	3.8	2.44



Table 2: PVC-U Compact Soil system: Socket Dimensions (mm)

Nominal Size (mm)	Ring-Seal	Internal Depth		Maximum Outside Diameter		
		Solvent Weld Without expansion cap		Ring-Seal	Solvent Weld Without expansion cap	
82	55	-	-	113	-	-
110	65	54	65	132	125	125
160	80	63	76	192	176	176

N.B. Dimensions are indicative only.

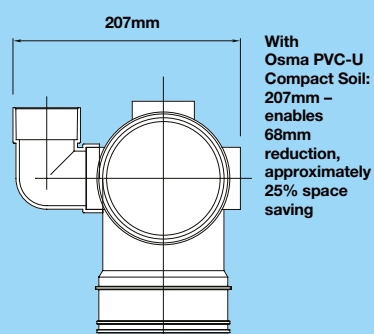
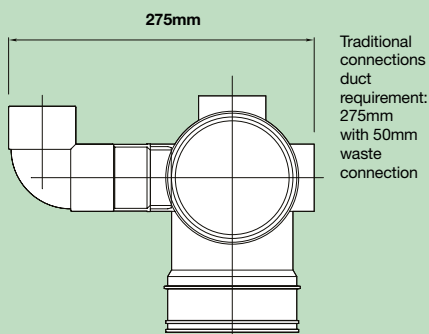

# Systems Overview

## Osma Compact

### Boss Adaptors

- ⌚ Compact 90° Boss Adaptors and Straight Boss Adaptors
- ⌚ Full range of size options 32mm, 40mm and 50mm

#### Straight Boss Adaptor

- ⌚ New boss locks adaptor into required 2.5° fall

### 90° Boss Adaptors

- ⌚ Innovative boss design to aid installation:
  - Cut-away on socket aligns with keyed shoulder on branch
  - Degree angle markings: enable visual indication of fall
  - Allows adaptor to rotate on boss but prevents negative fall
- ⌚ 32mm and 40mm 90° boss adaptors can locate, rotate and be adjusted within a 200mm cast hole



### Branches

- ⌚ Increased range of single, double and unequal branches with new boss configurations:
  - Unequal single branch 45°, for suspended drainage in car parks etc.
  - Unequal single 5 boss branch 90°, specifically for high rise developments
  - Single equal variable boss branch
- ⌚ 'Dimpled' drill guides aid location of drill when removing boss blanks



## Osma WC Connectors

Connectors for all WC configurations, including WC Manifold Branches, designed to connect up to 8 WCs onto 1 float:

- Colour: White
- Manufactured in PVC-U to BE EN 1329-1:2000
- Easy-Fit connectors manufactured in Polypropylene



## Osma PVC-C Solvent Weld Waste System

Connectors for all WC configurations, including WC Manifold Branches, designed to connect up to 8 WCs onto 1 float:

- 32, 40 and 50mm pipes and fittings
- Colour choice: Black, White and Olive
- Fire retardant properties
- Designed to withstand higher temperatures. The chlorinated PVC material has heat resistant properties
- UV resistant: suitable for exterior as well as interior installation
- Manufactured in PVC-C Chlorinated poly (vinyl chloride) to BS EN 1566-1: 2000



Table 3: PVC-C Solvent Weld Waste system: Pipe Dimensions (mm) and Weights (kg/m)

Nominal Size (mm)	DN/OD	Outside Diameter		Wall Thickness		Average Weight (kg/m)
		Min	Max	Min	Max	
32	36	36.1	36.5	1.8	2.2	0.29
40	43	42.7	43.1	1.9	2.3	0.36
50	55	55.7	56.1	2.0	2.4	0.50

Table 4: PVC-C Solvent Weld Waste system: Socket Dimensions (mm)

Nominal Size (mm)	DN/OD	Internal Depth (minimum)	Maximum Outside Diameter
32	36	21	41
40	43	23	48
50	55	28	61

# Systems Overview

## Osma Compact

### Osma Water Seal Traps

- 32, 40 and 50mm diameter domestic traps and accessories
- Colour: White only
- For use with all Osma waste systems and with copper pipe
- Comprehensive range including tubular, bottle, bath and washing machine traps, and shower gullies
- BS EN 1451-1:2000 plastic pipe should be first warmed in hot water before connection is made to the trap



### Osma Condensate Drainage

- For installation in association with new and replacement condensing boilers for domestic central heating
- For direct connection to Drainage Systems via waste or external soakaway
- Compatible with all Osma Overflow Systems
- Easy installation of all components
- Supports new energy efficiency regulations under Part L



### Osma Solvent Weld Overflow System

- 21.5 Solvent Weld system
- Colour: White only
- Removing overflow water from condensing boilers and cisterns/tanks
- Compatible with Osma Condensate Fittings
- Allows direct connection to condensing boilers fittings
- Secure permanent jointing
- Manufactured in ABS (fittings) and PVC-U (pipe)



Table 5: ABS and PVC-U Solvent Weld Overflow System: Pipe Dimensions (mm) and Weights (kg/m)

Nominal Size (mm)	Outside Diameter		Wall Thickness		Average Weight (kg/m)
	Min	Max	Min	Max	
21.5	21.5	21.63	1.09	1.27	0.145

Table 6: ABS and PVC-U Solvent Weld Overflow System: Socket Dimensions (mm)

Nominal Size (mm)	Internal Depth	Maximum Outside Diameter
21.5	26	27

# Estimating Data Osma Compact

## Estimating Data

The following data is provided to help estimation of quantities required for pipe support and jointing.

### Pipe Support

Pipes should be supported at the maximum centres shown opposite in Table 7.

### Offset Bends

Pipe Brackets should also be fitted around the Offset Bend or directly below.

Table 7: Maximum Pipe Support Centres

Pipe Size (mm)	Centres (m)	
	Vertical	Horizontal
21.5	0.5	0.5
32	1.2	0.5
40	1.2	0.5
50	1.2	0.6
82	2	1
110	2	1
160	2	1.2

## Jointing Material Allowances

### Lubricant Allowance

For push-fit ring-seal joints (approximate figures).

Table 8: Lubricant Usage Guide

Description	Part No.	Nominal Pipe Sizes (mm) No. of Joints					
		32	40	50	82	110	160
Silicone Lubricant 50g tube	4S391G	44	37	20	16	9	4

### Degreasing Cleaner/Solvent Cement Allowances

For solvent weld joints (approximate figures).

Table 9: Cleaner/Solvent Cement Usage Guide

Description	Part No.	Nominal Pipe Sizes (mm) No. of Joints						
		21.5	32	40	50	82	110	160
Degreasing Cleaner No.1 250ml can	4S380G	240	140	90	66	50	32	20
Solvent Cement No.2 250ml can	4S384G	180	90	60	40	16	11	6
Solvent Cement No.2 500ml can	4S385G	360	180	120	80	32	22	12



# Product Selector

## Osma Compact

### Introduction to Product Selector

The product selector gives details on the individual products in the following Wavin ranges:

- Osma PVC-U Compact Soil
- Osma WC Connectors
- Osma PVC-C Solvent Weld Waste
- Osma Water Seal Traps
- Osma Condensate Drainage
- Osma PVC-U and ABS Solvent Weld Overflow
- Osma Soil and Waste Accessories

For overviews of the ranges above see pages 3 to 6.

Please refer to separate brochures for further information on other Wavin Industrial and Commercial Systems ranges such as Wavin AS – Acoustic Soil System, Wavin HDPE and the K1 Tigris Multilayer Press-fit Plumbing System.







### Abbreviations

The following abbreviations are used in the product selector section to denote fittings or pipe type (also used in the Wavin price list). However, most products also have a bullet point detailing the product type i.e. two push-fit ends.

### Recycled Pipe

All 110mm and 160mm PVC-U plain ended and single socketed soil pipe in Osma is now manufactured using Wavin's Recycore Technology and contains at least 50% recycled PVC.



Key		
	P/E:	Pipe with both ends plain or fittings with one plain end and one special end
	D/SW:	Fittings with solvent sockets at all ends
	SW/S:	Fittings with one or more solvent sockets and one plain or special end
	S/SW:	Fittings with one or more push-fit (ring-seal) sockets but always one solvent socket
	S/S:	Pipe and fittings with one or more push-fit (ring-seal) sockets, but always one plain or special end
	D/S:	Fittings with push-fit (ring-seal) sockets at all ends

# Solvent Soil Osma Compact

## Pipe

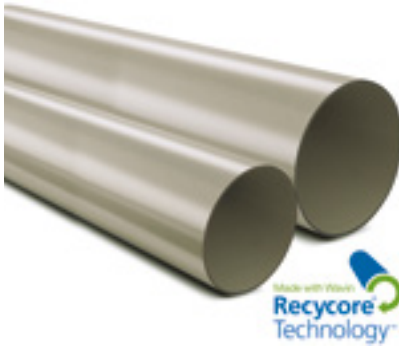

### Plain Ended Pipe

- 110/160mm sizes are made with Wavin Recycore technology – a multi-layer construction with over 50% recycled material in solid core
- 110/160 mm pipe sizes are BS EN 1453-1:2000 kitemarked but have exactly the same performance characteristics as BS EN 1329-1:2000
- 82mm pipe is standard PVC-U pipe, kitemarked to BS EN 1329-1

Material: PVC-U

Nominal Size (mm)	Part Number	Colour Option	Length (m)
82	3S074G ♡	Grey	4
110	4S073E ♡ △	Green	3
110	4S074E ♡ △	Green	4
160	6S074E ♡ △	Green	4

## Brackets

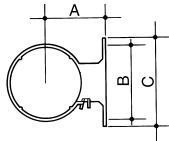

### Pipe Bracket

- For support centres, see page 18

Material: PVC-U



Nominal Size (mm)	Part Number	Colour Option	Dimensions (mm)				Fixing Hole
			A	B	C	D	
82	3S082G ♡	Grey	76	92	112	16	6.5 dia
110	4S082E ♡	Green	94	120	140	25	6.5 dia
160	6S082E ♡	Green	123	175	200	32	8 dia

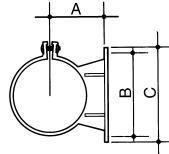

### Socket Bracket

- Position in the recessed area adjacent to the sealing-ring housing
- For support centres, see page 18

Material: PVC-U

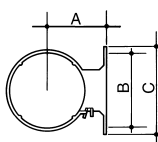
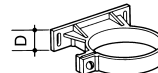

Nominal Size (mm)	Part Number	Colour Option	Dimensions (mm)				Fixing Hole
			A	B	C	D	
82	3S083G ♡	Grey	76	78	140	28.5	6.5 dia
110	4S083E ♡	Green	94	120	140	25	6.5 dia

# Solvent Soil Osma Compact

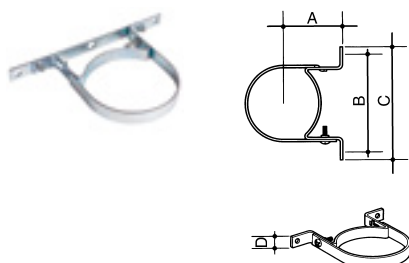

## Pipe or Socket Bracket

- Multi-functional support component that can be used for pipes or sockets
- When using as a socket bracket, always position unit in the recessed area adjacent to the sealing-ring housing
- For support centres, see page 18

Material: BZP – Coated Mild Steel

Nominal Size (mm)	Part Number	Dimensions (mm)				Fixing Hole
		A	B	C	D	
82	3S084 ▽	78	120	140	16	7 dia
110	4S084 ▽	94	160	180	20	7 dia
160	6S084 ▽	124	220	240	25	7 dia

## Suspended Bracketing System



### Adjustable Pipe Bracket Assembly

- Pack contains Threaded Rod, Threaded Bracket, Bracket Plate and Pipe/Socket Bracket
- For support centres, see page 18
- Not suitable for damp inaccessible voids

Material: BZP – Coated Mild Steel

Nominal Size (mm)	Part Number
110	4S086
160	6S086



### Adjustable Socket Bracket and Brace Assembly

- Pack contains Threaded Rod, Threaded Bracket, Bracket Plate, two Adjustable Braces, and Pipe/Socket Bracket
- For support centres, see page 18
- Not suitable for damp inaccessible voids

Material: BZP – Coated Mild Steel

Nominal Size (mm)	Part Number
110	4S085
160	6S085

# Solvent Soil Osma Compact

## Suspended Bracketing System – Components

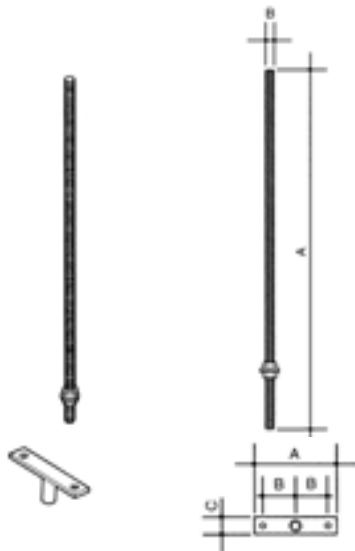

### M8 Threaded Rod

Material: BZP – Coated Mild Steel

Nominal Size (mm)	Part Number	Dimensions (mm)	
		A	B
–	–	500	8

### Threaded Bracket

Material: BZP – Coated Mild Steel

Nominal Size (mm)	Part Number	Dimensions (mm)		
		A	B	C
–	–	120	40	30



### Bracket Plate

Material: BZP – Coated Mild Steel

Nominal Size (mm)	Part Number	Dimensions (mm)			
		A	B	C	D
–	–	240	110	20	80

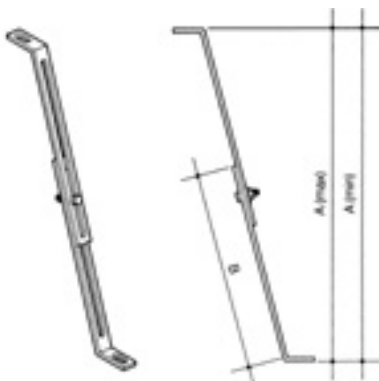

### Adjustable Brace

- Used for creating anchor points

Material: BZP – Coated Mild Steel

Nominal Size (mm)	Part Number	Dimensions (mm)		
		A min	A max	B
–	–	264	493	260

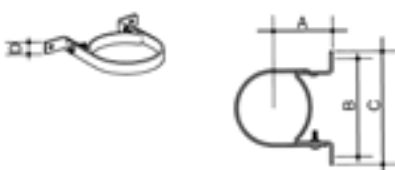

### Pipe or Socket Bracket

Material: BZP – Coated Mild Steel

Nominal Size (mm)	Part Number	Dimensions (mm)				Fixing Hole
		A	B	C	D	
110	–	94	160	180	20	7 dia
160	–	124	220	240	25	7 dia

# Solvent Soil Osma Compact

## Sockets

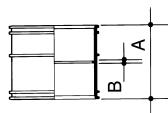

### D/SW Double Socket

- Solvent weld socket at each end

Material: PVC-U

Nominal Size (mm)	Part Number	Colour Option	Dimensions (mm)	
			A	B
110	4S104E ▾	●	98	2
160	6S104E ▾	●	119	3

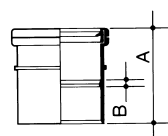

### S/SW Single Socket

- One solvent weld socket and one push-fit ring-seal socket
- Used for creating a fixed ring-seal joint on a plain-ended pipe or fitting, or where an expansion joint is required to accommodate thermal movement

Material: PVC-U, with Rubber seals

Nominal Size (mm)	Part Number	Colour Option	Dimensions (mm)	
			A	B
82	3S124G ▾	●	97	2
110	4S124E ▾	●	105	2
160	6S124E ▾	●	135	2

## Reducers

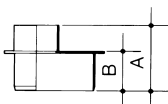

### SW/S Reducer

- Spigot connects to 110mm PVC-U solvent weld socket to BS EN 1329/ BS EN 1453
- Socket connects to 50mm ABS or PVC-C solvent weld pipe to BS EN 1455-1/ BS EN 1566-1

Material: PVC-U

Nominal Size (mm)	Part Number	Colour Option	Dimensions (mm)	
			A	B
110x50	4S496E ▾	●	89	50

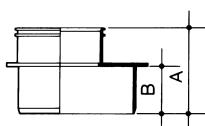

### SW/S Reducer

- Spigot connects to 160mm PVC-U solvent weld socket to BS EN 1329/ BS EN 1453
- Solvent weld socket connects to 110mm PVC-U pipe to BS EN 1329/ BS EN 1453

Material: PVC-U

Nominal Size (mm)	Part Number	Colour Option	Dimensions (mm)	
			A	B
160x110	6S499E ▾	●	117	65



# Solvent Soil Osma Compact

## Expansion Cap



### Expansion Cap

- With integral ring-seal
- Converts Osma Solvent Weld Soil sockets to push-fit expansion sockets
- See Design Guide for advice on accommodating thermal movement

Material: PVC-U, with Rubber seals

Nominal Size (mm)	Part Number	Colour Option	Dimensions (mm) A
110	4S416E	●	22
160	6S416E	●	27

## Bends

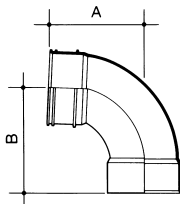

### D/SW Bend – 87.5°

- Two solvent weld sockets

Material: PVC-U

Nominal Size (mm)	Part Number	Colour Option	Dimensions (mm)	
			A	B
110	4S461E* ♡	●	152	166
160	6S461E* ♡	●	231	232

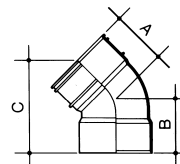

### D/SW Bend – 45°

- Two solvent weld sockets

Material: PVC-U

Nominal Size (mm)	Part Number	Colour Option	Dimensions (mm)		
			A	B	C
110	4S463E* ♡	●	87	87	148
160	6S463E* ♡	●	128	111	204

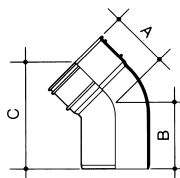

### SW/S Bend – 45°

- One plain end and one solvent weld socket

Material: PVC-U

Nominal Size (mm)	Part Number	Colour Option	Dimensions (mm)		
			A	B	C
110	4S263E* ♡	●	87	105	167

\*can be used in conjunction with expansion cap (4S416E/6S416E) to create push-fit ring soil socket

# Solvent Soil Osma Compact

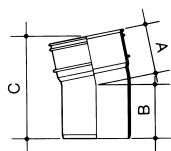

## SW/S Bend – 11.25°

- One plain end and one solvent weld socket

Material: PVC-U

Nominal Size (mm)	Part Number	Colour Option	Dimensions (mm)		
			A	B	C
110	4S268E* ♡	●	75	88	162

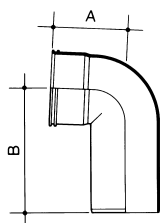

## SW/S Long-Tail Bend – 87.5°

- One plain end and one solvent weld socket

Material: PVC-U

Nominal Size (mm)	Part Number	Colour Option	Dimensions (mm)	
			A	B
110	4S260E* ♡	●	115	195

## Offset Bends

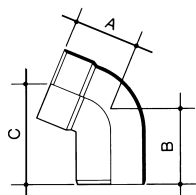

## SW/S Offset Bend – 67.5°

- One plain end and one solvent weld socket
- Minimum achievable offsets: 82 115mm, 110 137mm, 160 233mm

Material: PVC-U

Nominal Size (mm)	Part Number	Colour Option	Dimensions (mm)		
			A	B	C
82	3S435G ♡	●	92	87	123
110	4S435E* ♡	●	99	105	143

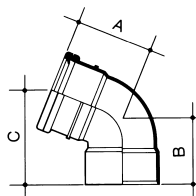

## S/SW Offset Bend – 67.5°

- One solvent weld socket and one push-fit ring-seal socket
- Minimum achievable offsets: 82 – 115mm, 110 – 137mm, 160 – 233mm

Material: PVC-U, with Rubber seals

Nominal Size (mm)	Part Number	Colour Option	Dimensions (mm)		
			A	B	C
82	3S440G ♡	●	95	87	123
110	4S440E* ♡	●	110	99	140

\*can be used in conjunction with expansion cap (4S416E) to create push-fit ring soil socket

# Solvent Soil Osma Compact

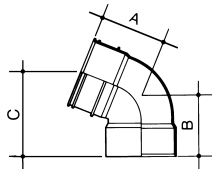

## D/SW Offset Bend – 67.5° (Top)

- Two solvent weld sockets
- Minimum achievable offsets: 196mm

Material: PVC-U

Nominal Size (mm)	Part Number	Colour Option	Dimensions (mm)		
			A	B	C
110	4S450E* ♡	●	108	102	123

## Boss Adaptors

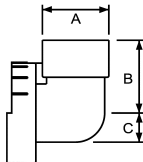

## Boss Adaptor 90° – Solvent Weld

- Adjustable fall angles, adaptor prevents negative fall

Material: PVC-U

Nominal Size (mm)	Part Number	Colour Option	Dimensions (mm)		
			A	B	C
40	2CS812SE ♡	●	48.5	52	21.5
50	2CS813SE ♡	●	61.5	64.5	28

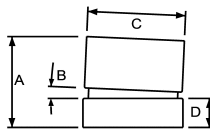

## Boss Adaptor Straight – Solvent Weld

- Keyway locks adaptors into required 2.5° fall

Material: PVC-U

Nominal Size (mm)	Part Number	Colour Option	Dimensions (mm)			
			A	B (deg)	C	D
32	2CS814SE ♡	●	47	2.5°	41.5	18
40	2CS815SE ♡	●	50	2.5°	48.5	18
50	2CS816SE ♡	●	57	2.5°	61.5	18

## Branches

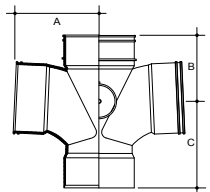

## D/SW Double 2-Boss Branch – 87.5°

- Four solvent weld sockets

Material: PVC-U

Nominal Size (mm)	Part Number	Colour Option	Dimensions (mm)		
			A	B	C
110	4CS829SE* ♡	●	140.5	110	144.5

\*can be used in conjunction with expansion cap (4S416E) to create push-fit ring soil socket

# Solvent Soil Osma Compact

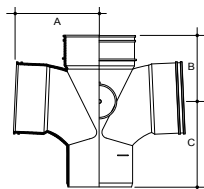

## SW/S Double 2-Boss Branch – 87.5°

- One plain end and three solvent weld sockets

Material: PVC-U

Nominal Size (mm)	Part Number	Colour Option	Dimensions (mm)		
			A	B	C
110	4CS831SE* ♡	●	140.5	110	141.5

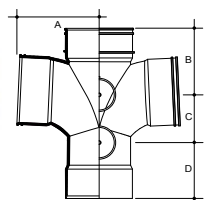

## D/SW Double 4-Boss Branch – 87.5°

- Four solvent weld sockets

Material: PVC-U

Nominal Size (mm)	Part Number	Colour Option	Dimensions (mm)		
			A	B	C
110	4CS832SE* ♡	●	140.5	16.5	83.5

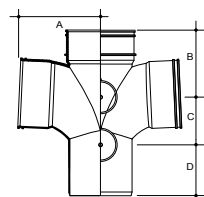

## SW/S 4-Boss Branch – 87.5°

- One plain end and three solvent weld sockets

Material: PVC-U

Nominal Size (mm)	Part Number	Colour Option	Dimensions (mm)		
			A	B	C
110	4CS834SE* ♡	●	140.5	116.5	83.5

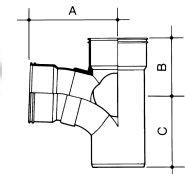

## SW/S Corner Branch – 87.5°

- One plain end and three solvent weld sockets

Material: PVC-U

Nominal Size (mm)	Part Number	Colour Option	Dimensions (mm)		
			A	B	C
110	4CS491SE* ♡	●	179	113	144

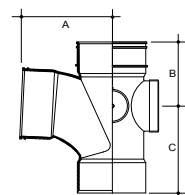

## D/SW 2-Boss Access Branch – 87.5°

- Three solvent weld sockets

Material: PVC-U

Nominal Size (mm)	Part Number	Colour Option	Dimensions (mm)		
			A	B	C
110	4CS893SE* ♡	●	159	112	152

\*can be used in conjunction with expansion cap (4S416E) to create push-fit ring soil socket

# Solvent Soil Osma Compact

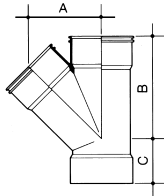

## D/SW Single Branch – 45°

- Three solvent weld sockets

Material: PVC-U

Nominal Size (mm)	Part Number	Colour Option	Dimensions (mm)		
			A	B	C
110	4S410E* ♡	●	136	192	85

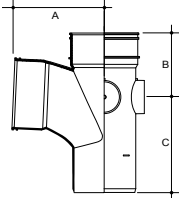

## SW/S Single 3-Boss Branch – 87.5°

- One plain end and two solvent weld sockets

Material: PVC-U

Nominal Size (mm)	Part Number	Colour Option	Dimensions (mm)		
			A	B	C
110	4CS889SE* ♡	●	159	112	167

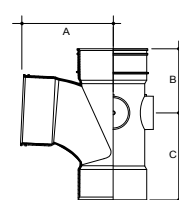

## D/SW Single 3-Boss Branch – 87.5°

- Three solvent weld sockets

Material: PVC-U

Nominal Size (mm)	Part Number	Colour Option	Dimensions (mm)		
			A	B	C
110	4CS890SE* ♡	●	159	112	152

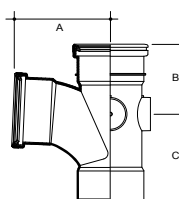

## S/SW Single 3-Boss Branch – 87.5°

- Two push-fit sockets and one solvent weld socket

Material: PVC-U

Nominal Size (mm)	Part Number	Colour Option	Dimensions (mm)		
			A	B	C
110	4CS892SE* ♡	●	159	112	167

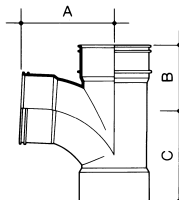

## D/SW Single Branch – 87.5°

- Three solvent weld sockets

Material: PVC-U

Nominal Size (mm)	Part Number	Colour Option	Dimensions (mm)		
			A	B	C
160	6S490E* ♡	●	222	161	240

\*can be used in conjunction with expansion cap (4S416E/6S416E) to create push-fit ring soil socket



# Solvent Soil Osma Compact

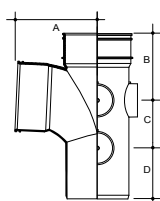

## SW/S Single 5-Boss Branch – 87.5°

- One plain end and two solvent weld sockets

Material: PVC-U

Nominal Size (mm)	Part Number	Colour Option	Dimensions (mm)			
			A	B	C	D
110	4CS895SE* ♡	●	140.5	16.5	83.5	89

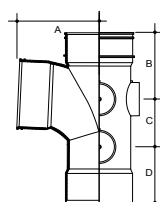

## D/SW Single 5-Boss Branch

- Three solvent weld sockets
- 110mm branch

Material: PVC-U

Nominal Size (mm)	Part Number	Colour Option	Dimensions (mm)			
			A	B	C	D
110	4CS897SE* ♡	●	140.5	116.5	83.5	97.5

## Manifold

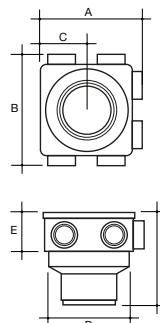

## SW/S 6 Boss Manifold

- 6 boss connection points (No boss adaptors required)
- Dual 40/50mm solvent weld connection
- Compact design, 163mm body sits easily into 200mm drilled or formed hole
- Branch low in fitting: 132mm from centreline of branch horizontal inlet to 50mm spigot invert
- Horizontal instead of vertical waste connection – no upstanding bends required

Material: PVC-U

Nominal Size (mm)	Part Number	Colour Option	Dimensions (mm)					
			A	B	C	D	E	F
110	4S597E	●	204	222	94	163	79	184

## Bossed Pipes

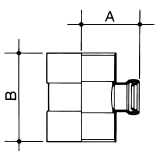

## D/SW Bossed Pipe (Solvent Weld)

- Connects to 32mm [1¼"] or 40mm [1½"] plastic pipe to BS EN 1451-1/BS EN 1455-1/BS EN 1566-1, or to copper pipe manufactured to BS 659 or BS 2871
- Two solvent weld sockets
- One push-fit socket position

Material: PVC-U, with Rubber seals

Nominal Size (mm)	Part Number	Colour Option	Dimensions (mm)		
			A	B	C
110x32	4CS483E ♡	●	95	87	123
110x40	4CS484E ♡	●	110	99	140

\*can be used in conjunction with expansion cap (4S416E) to create push-fit ring soil socket

# Solvent Soil Osma Compact

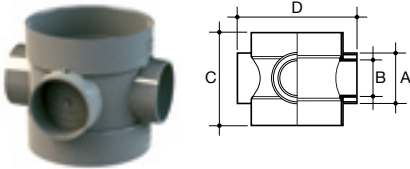

## D/SW Short 3-Boss Pipe

- Three closed boss socket positions for use with the appropriate Boss Socket Adaptor (page 25)
- Three closed 40mm [1½"] spigot tail positions also allow for direct connection of 40mm [1½"] solvent weld sockets

Material: PVC-U

Nominal Size (mm)	Part Number	Colour Option	Dimensions (mm)			
			A	B	C	D
110	4CS588SE	●	56	43	124	74

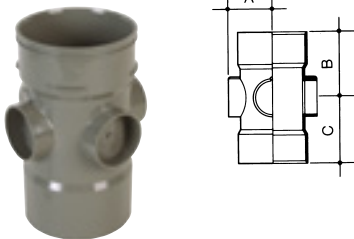

## D/SW Bossed Pipe

- Two solvent weld sockets
- Three closed boss socket positions and one open to receive appropriate Boss Socket Adaptor

Material: PVC-U

Nominal Size (mm)	Part Number	Colour Option	Dimensions (mm)		
			A	B	C
110	4CS586SE*	●	70	104	115

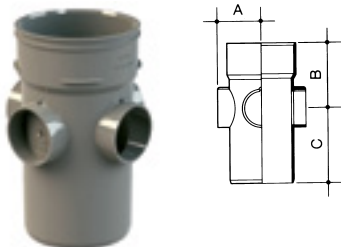

## SW/S Bossed Pipe

- One plain end and one solvent weld socket
- Three closed boss socket positions and one open to receive appropriate Boss Socket Adaptor (page 25)

Material: PVC-U

Nominal Size (mm)	Part Number	Colour Option	Dimensions (mm)		
			A	B	C
110	4CS585SE*	●	70	100	119

## Strap Boss

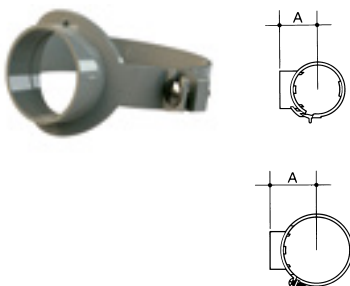

## Strap Boss

- For making side connections on BS EN 1329 plastic pipe after construction
- Use in conjunction with Boss Socket Adaptor (page 25)

Material: PVC-U

Nominal Size (mm)	Part Number	Colour Option	Dimensions (mm)	
			A	
110	4CS319SE	●	77	

\*can be used in conjunction with expansion cap (4S416E) to create push-fit ring soil socket

# Solvent Soil Osma Compact

## Access Fittings

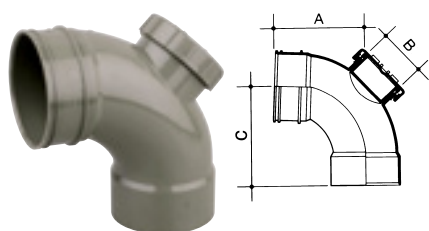

### D/SW Access Bend – 87.5°

- Two solvent weld sockets
- Fitted with screwed access cover

Material: PVC-U, with Rubber seals

Nominal Size (mm)	Part Number	Colour Option	Dimensions (mm)		
			A	B	C
110	4S469E* ♡	●	152	80	166

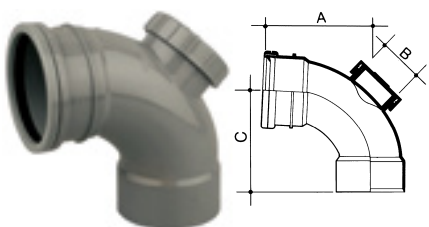

### S/SW Access Bend – 87.5°

- One solvent weld socket and one push-fit ring-seal socket
- Fitted with screwed access cover

Material: PVC-U, with Rubber seals

Nominal Size (mm)	Part Number	Colour Option	Dimensions (mm)		
			A	B	C
110	4S469E ♡	●	163	80	160

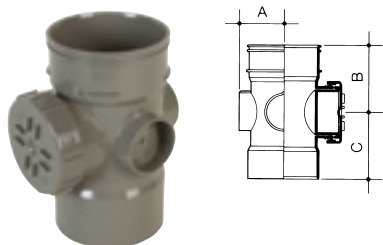

### D/SW 3-Boss Access Pipe

- Two solvent weld sockets
- Fitted with screwed access cover

Material: PVC-U

Nominal Size (mm)	Part Number	Colour Option	Dimensions (mm)		
			A	B	C
110	4CS474SE* ♡	●	70	104	115

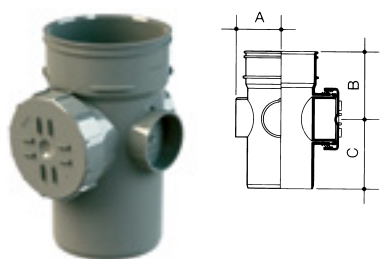

### SW/S Bossed Access Pipe

- One plain end and one solvent weld socket
- Three closed boss socket positions
- Fitted with screwed access cover

Material: PVC-U

Nominal Size (mm)	Part Number	Colour Option	Dimensions (mm)		
			A	B	C
110	4CS574SE* ♡	●	70	100	119
160	6CS474SE* ♡	●	124	131	150

\*can be used in conjunction with expansion cap (4S416E/6S416E) to create push-fit ring soil socket

# Solvent Soil Osma Compact

## Plugs

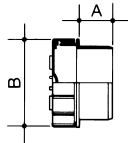

### P/E Access Plug

- Fits into a solvent weld socket to provide an access point
- Fitted with screwed access cover

Material: PVC-U

Nominal Size (mm)	Part Number	Colour Option	Dimensions (mm)	
			A	B
82	3S292G		56	100
110	4S292E		50	132
160	6S292E		58	188

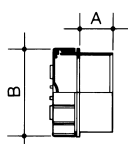

### SW/S Access Plug

- Glues over a pipe spigot to provide an access point
- Fitted with screwed access cover

Material: PVC-U

Nominal Size (mm)	Part Number	Colour Option	Dimensions (mm)	
			A	B
110	4S492E		50	137

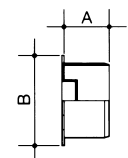

### P/E Socket Plug

- For use as a blanking plug only

Material: PVC-U

Nominal Size (mm)	Part Number	Colour Option	Dimensions (mm)	
			A	B
110	4S296E		54	132

## Terminal Fittings

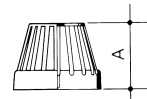

### Balloon Grating

Material: PVC-U

Nominal Size (mm)	Part Number	Colour Option	Dimensions (mm)	
			A	
82	3S302G		94	
110	4S302E		90	

# Solvent Soil Osma Compact

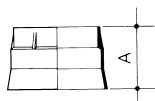

## Weathering Collar

- Used to maintain a watertight seal between pipe and traditional lead or aluminium flashing
- To be solvent welded to pipe using Solvent Cement Filler

Material: PVC-U

Nominal Size (mm)	Part Number	Colour Option	Dimensions (mm) A
82	3S300G	●	62
110	4S300E	●	86
160	6S300E	●	58

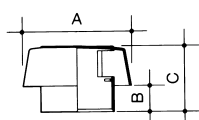

## SW/S Vent Cowl

- Provides an alternative weather-proof termination for soil and vent pipe, or outlet for a mechanical-ventilation system
- Can be used in a vertical or horizontal position

Material: PVC-U

Nominal Size (mm)	Part Number	Colour Option	Dimensions (mm) A B C
110	4S310E ♡	●	172 40 100

## Roof Outlet

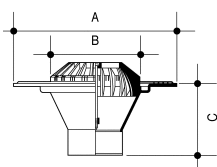

## SW/S Domed Roof Outlet

- Outlet capacity (outlet at centre of roof):  
82mm outlet 2.97 l/s; 143m<sup>2</sup> max. roof area  
110mm outlet 4.35 l/s; 209m<sup>2</sup> max. roof area
- Fitted with:  
82mm outlet solvent-weld socket  
110mm outlet solvent-weld socket

Material: PVC-U

Nominal Size (mm)	Part Number	Colour Option	Dimensions (mm) A B C
82	3S414G	●	270 130 124
110	4S414G	●	338 188 147



# Ring-Seal Soil Osma Compact

## Pipe

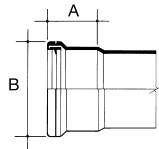

### Socketed Pipe

- One plain end, one ring-seal socket
- 110/160mm sizes are made with Wavin Recycore technology – a multi-layer construction with over 50% recycled material in solid core
- 110/160 mm pipe sizes are BS EN 1453-1:2000 kitemarked but have exactly the same performance characteristics as BS EN 1329-1:2000
- 82mm pipe is standard PVC-U pipe, kitemarked to BS EN 1329-1

Material: PVC-U, with Rubber seals



Nominal Size (mm)	Part Number	Colour Option	Length (m)	Dimensions (mm)	
				A	(O/D) B
82	3S043G ♡	●	3	51	104
82	3S044G ♡	●	4	51	104
110	4S044E ♡ △	●	4	65	132
160	6S043E ♡ △	●	3	88	191

## Socket

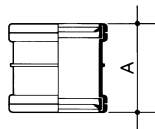

### D/S Double Socket – for repairs

- Push-fit ring-seal socket at each end
- Used as a slip coupler for making repairs

Material: PVC-U, with Rubber seals

Nominal Size (mm)	Part Number	Colour Option	Dimensions (mm) A
82	3S105G ♡	●	102
110	4S105E ♡	●	111
160	6S105E ♡	●	145

## Connector

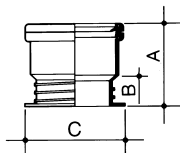

### S/S Connector to Cast-Iron or Clay Drain Socket

- Connector to BS 1211 or BS 437 cast-iron socket or BS 65 clay drain socket

Material: PVC-U, with Rubber seals

Nominal Size (mm)	Part Number	Colour Option	Dimensions (mm)		
			A	B	C
110	4S107E ♡	●	121	51	134

# Ring-Seal Soil Osma Compact

## Reducers

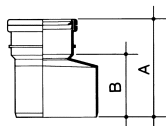

### S/S Reducer

- One plain end and one push-fit socket

Material: PVC-U, with Rubber seals

Nominal Size (mm)	Part Number	Colour Option	Dimensions (mm)	
			A	B
82x50	3S094G ♡	●	119	68

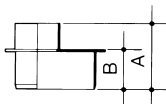

### S/S Reducer

- One plain end and one push-fit socket

Material: PVC-U, with Rubber seals

Nominal Size (mm)	Part Number	Colour Option	Dimensions (mm)	
			A	B
110x50	4S096E ♡	●	103	53

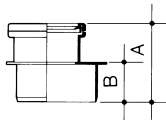

### S/S Reducer

- One plain end and one push-fit socket

Material: PVC-U, with Rubber seals

Nominal Size (mm)	Part Number	Colour Option	Dimensions (mm)	
			A	B
110x82	4S095E ♡	●	103	53

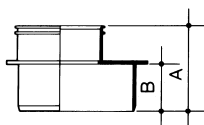

### S/S Reducer

- One plain end and one push-fit socket

Material: PVC-U, with Rubber seals

Nominal Size (mm)	Part Number	Colour Option	Dimensions (mm)	
			A	B
160x110	6S099E ♡	●	130	68

## Bends

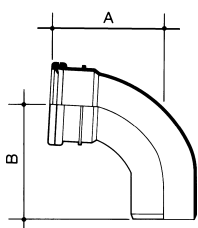

### S/S Bend – 87.5°

- One plain end and one push-fit ring-seal socket

Material: PVC-U, with Rubber seals

Nominal Size (mm)	Part Number	Colour Option	Dimensions (mm)	
			A	B
82	3S161G ♡	●	128	125
110	4S161E ♡	●	162	160

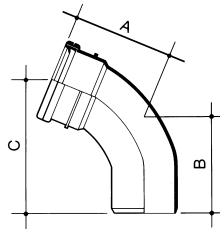

#### S/S Bend – 67.5°

- One plain end and one push-fit ring-seal socket

Material: PVC-U, with Rubber seals

Nominal Size (mm)	Part Number	Colour Option	Dimensions (mm)		
			A	B	C
82	3S162G ▽	●	132	121	180

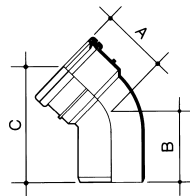

#### S/S Bend – 45°

- One plain end and one push-fit ring-seal socket

Material: PVC-U, with Rubber seals

Nominal Size (mm)	Part Number	Colour Option	Dimensions (mm)		
			A	B	C
82	3S163G ▽	●	81	70	126

## Adjustable Bend

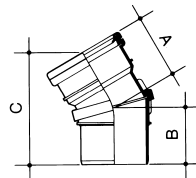

#### Adjustable Bend – 30°

- One plain end and one push-fit ring-seal socket
- Variable angle up to 30°
- Rotate segments to achieve required change of direction (flow arrow on socket indicates orientation of fitting)
- BBA certificated (Certificate No. 89/2174)

Material: Polypropylene, with Rubber seals

Nominal Size (mm)	Part Number	Colour Option	Dimensions (mm)		
			A	B	C
110	4S173E ▲	●	97	90	180

## Boss Adaptors

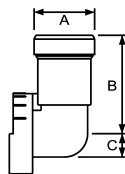

#### Boss Adaptor 90° – Push-fit

- Adjustable fall angles, adaptor prevents negative fall

Material: PVC-U

Nominal Size (mm)	Part Number	Colour Option	Dimensions (mm)		
			A	B	C
32	2CS801SE ▽	●	47.5	77	18
40	2CS802SE ▽	●	55.5	83.5	21.5

# Ring-Seal Soil Osma Compact

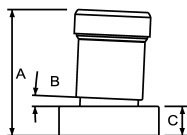

## Boss Adaptor Straight – Push-fit

- Keyway locks adaptors into required 2.5° fall

Material: PVC-U

Nominal Size (mm)	Part Number	Colour Option	Dimensions (mm)		
			A	B (deg)	C
32	2CS804SE ▾	●	78.5	2.5°	18
40	2CS805SE ▾	●	82	2.5°	18

## Branches

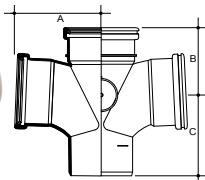

## S/S Double 2-Boss Branch – 87.5°

- One plain end and three push-fit sockets

Material: PVC-U

Nominal Size (mm)	Part Number	Colour Option	Dimensions (mm)		
			A	B	C
110	4CS830SE ▾	●	148.5	118	141.5

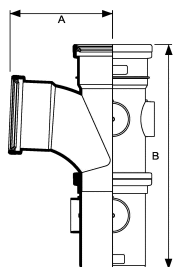

## S/S 110mm Variable 6-Boss Branch – 87.5°

- One plain end and two push-fit sockets
- Rotating branch connection

Material: PVC-U

Nominal Size (mm)	Part Number	Colour Option	Dimensions (mm)	
			A	B
110	4CS852SE ▾	●	172	376

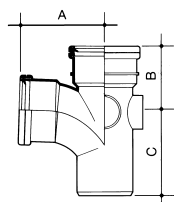

## S/S Single Branch – 87.5°

- One plain end and two push-fit ring-seal sockets
- 82mm has two boss sockets, 110mm has three boss sockets

Material: PVC-U, with Rubber seals

Nominal Size (mm)	Part Number	Colour Option	Dimensions (mm)		
			A	B	C
82	3CS190SG ▾	●	155	118	146
110	4CS891SE ▾	●	169.5	122.5	167

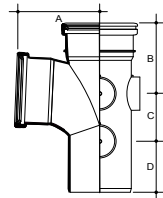

### S/S Single 5-Boss Branch

- One plain end and two push-fit sockets

Material: PVC-U

Nominal Size (mm)	Part Number	Colour Option	Dimensions (mm)			
			A	B	C	D
110	4CS896SE ♡	●	146.5	123.5	83.5	89

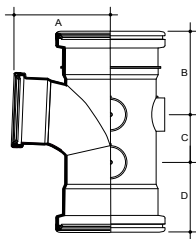

### D/S Unequal Single 5-Boss Branch - 87.5°

- Three push-fit sockets
- 110mm branch

Material: PVC-U

Nominal Size (mm)	Part Number	Colour Option	Dimensions (mm)			
			A	B	C	D
160	6CS897SE ♡	●	169.5	146	83.5	122

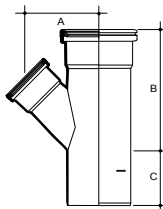

### S/S Unequal Junction - 45°

- One plain end and two push-fit sockets
- 110mm branch

Material: PVC-U

Nominal Size (mm)	Part Number	Colour Option	Dimensions (mm)		
			A	B	C
160	6CS218E ♡	●	184	303.5	83.5

## Manifolds

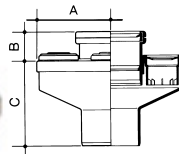

### S/S Soil Manifold

- One plain end and one push-fit ring-seal socket
- Permits up to three 50mm connections to be made at floor level
- Complies with BS EN 12056-2:2000 clause ND. 3.3.2
- Make connections using 2CS354 (below), 2CS355 or 2CS356
- Minimum installation aperture: 240mm square

Material: PVC-U, with Rubber seals

Nominal Size (mm)	Part Number	Colour Option	Dimensions (mm)			
			A	B	C	D
110	4S595E ♡	●	138	55	160	275



# Ring-Seal Soil Osma Compact



## All-Fit Reducer – 40:32mm

- Connects to 32mm plastic pipe to BS EN 1451-1/BS EN 1455-1/ BS EN 1566-1, or to copper pipe manufactured to BS 659 or BS 2871
- Use with 2S355W (below) when a bend is required

Material: Polypropylene

Nominal Size (mm)	Part Number	Colour Option	Dimensions (mm)	
			A	
40	4Z124W	○	54	

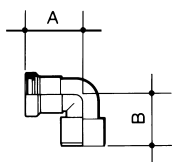

## All-Fit Reduction Bend – 50:40mm

- Connects to 40mm plastic pipe to BS EN 1451-1/BS EN 1455-1/ BS EN 1566-1, or to copper pipe manufactured to BS 659 or BS 2871

Material: Polypropylene

Nominal Size (mm)	Part Number	Colour Option	Dimensions (mm)	
			A	B
50	2S355W	○	70	65

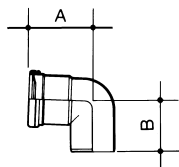

## All-Fit 90° Spigot Bend – 50mm

- Connects to 50mm plastic pipe to BS EN 1451-1/BS EN 1455-1/ BS EN 1566-1, or to copper pipe manufactured to BS 659 or BS 2871

Material: ABS

Nominal Size (mm)	Part Number	Colour Option	Dimensions (mm)	
			A	B
50	2S356W	○	79	64

## Bossed Pipes

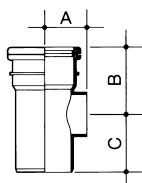

## S/S Bossed Pipe

- One plain end and one push-fit ring-seal socket
- Use in conjunction with Boss Socket Adaptor (page 15)

Material: PVC-U, with Rubber seals

Nominal Size (mm)	Part Number	Colour Option	Dimensions (mm)		
			A	B	C
82	3CS649SG	●	61	90	86

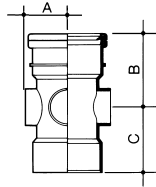

#### S/SW Bossed Pipe

- One plain end and one push-fit ring-seal socket
- Three closed boss socket positions and one open to receive appropriate Boss Socket Adaptor (page 15)

Material: PVC-U, with Rubber seals

Nominal Size (mm)	Part Number	Colour Option	Dimensions (mm)		
			A	B	C
110	4CS590SE ♡	●	70	103	116

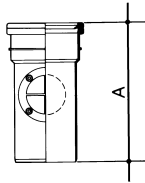

#### S/S Access Pipe

- One plain end and one push-fit ring-seal socket
- Fitted with bolted, oval access door

Material: PVC-U, with Rubber seals

Nominal Size (mm)	Part Number	Colour Option	Dimensions (mm)
			A
82	3S274G ♡	●	255

# Solvent Waste Osma Compact

## Pipe



### Plain-Ended Pipe

Material: PVC-C

Nominal Size (mm)	Part Number	Colour Option	Length (m)
32	4M073	● ● ○	3
40	5M073	● ● ○	3
50	2M073	● ● ○	3

## Bracket

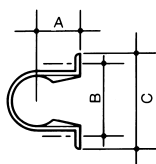

### Pipe Bracket

- For support centres, see page 7

Material: ABS

Nominal Size (mm)	Part Number	Colour Option	Dimensions (mm)		
			A	B	C
32	4M081	● ● ○	31	67	85
40	5M081	● ● ○	34	73	92
50	2M081	● ● ○	58	82	102

## Sockets

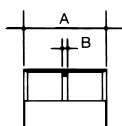

### Double Socket

- For connecting lengths of PVC-C pipe

Material: PVC-C

Nominal Size (mm)	Part Number	Colour Option	Dimensions (mm)	
			A	B
32	4M104	● ● ○	42	2
40	5M104	● ● ○	48	2
50	2M104	● ● ○	68	2

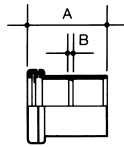

### Expansion Socket

- For creating an expansion joint where provision for thermal movement is required.
- Solvent weld socket and push-fit ring-seal socket
- Push-fit socket connects to 32mm [1¼"], 40mm [1½"] or 50mm [2"] pipe to BS EN 1455-1 and BS EN 1566-1
- Also connects to copper pipe to BS 659 and BS 2871

Material: PVC-C

Nominal Size (mm)	Part Number	Colour Option	Dimensions (mm)	
			A	B
32	4M124 ▽	● ○	64	3
40	5M124 ▽	● ○	65	3
50	2M104 ▽	● ○	72	3

## Bends

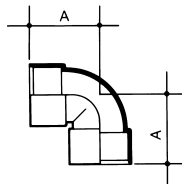

### Knuckle Bend – 90°

Material: PVC-C

Nominal Size (mm)	Part Number	Colour Option	Dimensions (mm)
			A
32	4M160 ▽	● ● ○	40
40	5M160 ▽	● ● ○	52
50	2M160 ▽	● ● ○	60

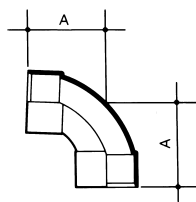

### Bend – 87.5°

Material: PVC-C

Nominal Size (mm)	Part Number	Colour Option	Dimensions (mm)
			A
32	4M161 ▽	● ● ○	47
40	5M161 ▽	● ● ○	58
50	2M161 ▽	● ● ○	72

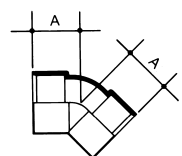

### Bend – 45°

Material: PVC-C

Nominal Size (mm)	Part Number	Colour Option	Dimensions (mm)
			A
32	4M163 ▽	● ● ○	31
40	5M163 ▽	● ● ○	43
50	2M163 ▽	● ● ○	48

# Solvent Waste Osma Compact

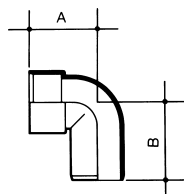

## Spigot Bend – 90°

Material: PVC-C

Nominal Size (mm)	Part Number	Colour Option	Dimensions (mm)	
			A	B
32	4M260 ▽	● ● ○	49	53
40	5M260 ▽	● ● ○	51	91
50	2M260 ▽	● ● ○	63	96

## Tee

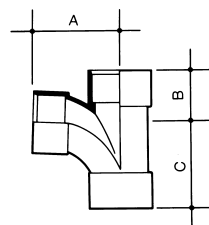

## Tee – 87.5°

Material: PVC-C

Nominal Size (mm)	Part Number	Colour Option	Dimensions (mm)		
			A	B	C
32	4M190 ▽	● ● ○	47	43	51
40	5M190 ▽	● ● ○	56	51	59
50	2M190 ▽	● ● ○	67	62	68

## Plug

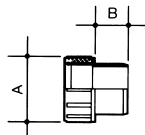

## P/E Access Plug

- Fits into a solvent weld socket to provide an access point
- Fitted with screwed access cover
- See Design and Installation Guide and BS EN 12056:2000 regarding provision of access

Material: PVC-C

Nominal Size (mm)	Part Number	Colour Option	Dimensions (mm)	
			A	B
32	4M292 ▽	● ● ○	43	20
40	5M292 ▽	● ● ○	51	22
50	2M292 ▽	● ● ○	63.5	29

## Reducer

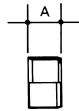

### Reducer

- Fits inside a 40mm [1½"] solvent weld socket to BS EN 1455-1 and BS EN 1566-1
- Allows connection of a 32mm [1¼"] waste pipe to either 40mm [1½"] or 50mm [2"] pipe
- Also allows a 40mm [1½"] pipe to be connected to a 50mm [2"] pipe

Material: PVC-C

Nominal Size (mm)	Part Number	Colour Option	Dimensions (mm) A
40x32	5M455 ♡	● ● ○	23
50x32	2M458 ♡	● ● ○	30
50x40	2M456 ♡	● ● ○	30

*NOTE: For compatible connectors and adaptors see the ABS Solvent Weld range.*



# Accessories

## Osma Compact

### WC Manifold Branches (incorporating gasket)

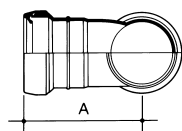

#### S/SW Manifold Branch – Straight

- One solvent weld and one push-fit socket (right hand illustrated)

Material: PVC-U

Nominal Size (mm)	Part Number	Colour Option	Dimensions (mm)	
			A	Effective Length
110	4S601W	○	180	132

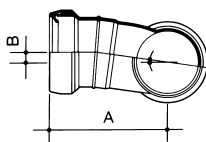

#### S/SW Manifold Branch – 8°

- One solvent weld and one push-fit socket (right hand illustrated)

Material: PVC-U

Nominal Size (mm)	Part Number	Colour Option	Dimensions (mm)		
			A	B	Effective Length
110 LH	4S602W	○	180	16	132
110 RH	4S612W	○	180	16	132

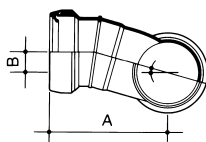

#### S/SW Manifold Branch – 15.5°

- One solvent weld and one push-fit socket (right hand illustrated)

Material: PVC-U

Nominal Size (mm)	Part Number	Colour Option	Dimensions (mm)		
			A	B	Effective Length
110 LH	4S603W	○	180	32	132
110 RH	4S613W	○	180	32	132

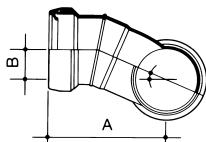

#### S/SW Manifold Branch – 23°

- One solvent weld and one push-fit socket (right hand illustrated)

Material: PVC-U

Nominal Size (mm)	Part Number	Colour Option	Dimensions (mm)		
			A	B	Effective Length
110 LH	4S604W	○	180	48	132
110 RH	4S614W	○	180	48	132

NOTE: All Manifold Branches are fitted with a gasket for direct connection to the outlets of WC's manufactured to BS 5503  
See Design and Installation Guide and BS EN 12056:2000 on the provision of access

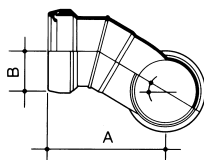

#### S/SW Manifold Branch – 30.5°

- One solvent weld and one push-fit socket (right hand illustrated)

Material: PVC-U

Nominal Size (mm)	Part Number	Colour Option	Dimensions (mm)		
			A	B	Effective Length
110 LH	4S605W ♡	○	180	64	132
110 RH	4S615W ♡	○	180	64	132

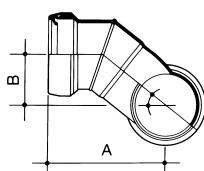

#### S/SW Manifold Branch – 38°

- One solvent weld and one push-fit socket (right hand illustrated)

Material: PVC-U

Nominal Size (mm)	Part Number	Colour Option	Dimensions (mm)		
			A	B	Effective Length
110 LH	4S606W ♡	○	180	80	132
110 RH	4S616W ♡	○	180	80	132

### WC Connectors (incorporating gasket)

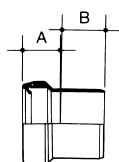

#### P/E Connector – 2.5°

- One plain end

Material: PVC-U

Nominal Size (mm)	Part Number	Colour Option	Dimensions (mm)	
			A	B
110	4S791W ♡	○	53	63

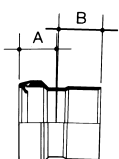

#### SW/S Connector – 2.5°

- One solvent weld socket

Material: PVC-U

Nominal Size (mm)	Part Number	Colour Option	Dimensions (mm)	
			A	B
110	4S792W ♡	○	53	63

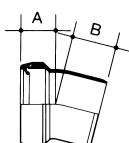

#### P/E Connector – 14°

- One plain end

Material: PVC-U

Nominal Size (mm)	Part Number	Colour Option	Dimensions (mm)	
			A	B
110	4S711W ♡	○	53	63

NOTE: Manifold Branches and WC Connectors are fitted with a gasket for direct connection to the outlets of WC's manufactured to BS 5503

# Accessories

## Osma Compact

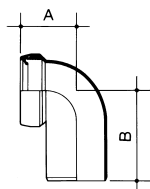

### P/E Connector – 90°

- One plain end

Material: PVC-U

Nominal Size (mm)	Part Number	Colour Option	Dimensions (mm)	
			A	B
110	4S771W ♡	○	109	173

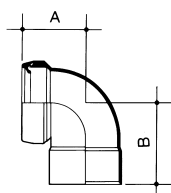

### SW/S Connector – 90°

- One solvent weld socket

Material: PVC-U

Nominal Size (mm)	Part Number	Colour Option	Dimensions (mm)	
			A	B
110	4S772W ♡	○	109	134

**NOTE:** Manifold Branches and WC Connectors are fitted with a gasket for direct connection to the outlets of WC's manufactured to BS 5503

See Design and Installation Guide and BS EN 12056:2000 on the provision of access

## WC Connectors (gasket to be fitted)

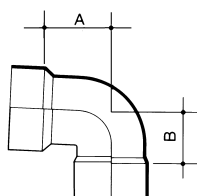

### SW/S Connector – 87.5°

- One solvent weld socket
- For direct connection to WC's to BS 1213 when fitted with the appropriate Gasket 4S120W or 4S121W

Material: PVC-U

Nominal Size (mm)	Part Number	Colour Option	Dimensions (mm)	
			A	B
110	4S745W ♡	○	106	77

## WC Gasket



### S/S Access Pipe – WC Gasket

- For use with Connectors 4S730W, 4S731W, 4S745W and 4S746W
- Connects to WC spigots as follows:  
CWC121 suits 4" to 4¼" spigots  
CWC120 suits 4¼" to 4½" spigots

Material: Synthetic Rubber

Nominal Size (mm)	Part Number	Colour Option	Dimensions (inch)
			WC Spigot
110	4S121W	○	4" to 4¼"
110	4S120W	○	4¼" to 4½"

## WC Connectors (ancillaries)

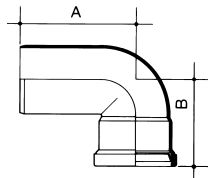

### S/S Long-Tail Bend – 87.5°

- For use with WC Connectors
- Do NOT use as a WC connector

Material: PVC-U

Nominal Size (mm)	Part Number	Colour Option	Dimensions (mm)	
			A	B
110	4S790W ♡	○	195	134



### Plain-Ended Pipe – 600mm

- For use with WC Connectors where connection to SVP is visible

Material: PVC-U

Nominal Size (mm)	Part Number	Colour Option	Dimensions (mm)	
			Length	
110	4S600W ♡ △	○	600	

## Easy-Fit Pan Connectors

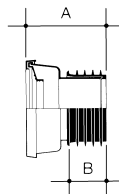

### Easy-Fit Connector – Straight

- For use where the WC outlet is horizontal to the branch connection
- Fitted with a gasket for direct connection to the outlets of WC's manufactured to BS 5503
- Spigot end of 3½" Connector WC003W incorporates gasket for direct insertion into plain end of 3½" cast-iron pipe to BS 416
- Spigot end of 4" Connector WC004W incorporates gasket for direct insertion into plain end of 4" pipe e.g. cast-iron, plastic or clay

Material: Polypropylene

Nominal Size (inch)	Part Number	Colour Option	Dimensions (mm)	
			A	B
3½"	WC003W	○	116	52
4"	WC004W	○	116	52

# Accessories

## Osma Compact

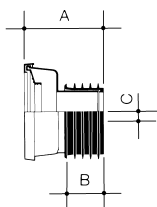

### Easy-Fit Connector – Offset

- For use where the WC outlet is not directly in line with the branch connection. Correct alignment obtained by turning the connector
- Fitted with a gasket for direct connection to the outlets of WC's manufactured to BS 5503
- Spigot end of 3½" Connector WC003W incorporates gasket for direct insertion into plain end of 3½" cast-iron pipe to BS 416
- Spigot end of 4" Connector WC004W incorporates gasket for direct insertion into plain end of 4" pipe e.g. cast-iron, plastic or clay

Material: Polypropylene

Nominal Size (inch)	Part Number	Colour Option	Dimensions (mm)		
			A	B	C
4"	WC204W	○	116	52	16

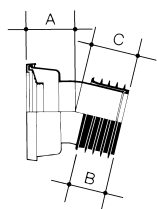

### Easy-Fit Connector – 14°

- Converts a horizontal WC outlet to an angle of 14° (76°)
- Spigot end of 3½" Connector incorporates gasket for direct insertion into plain end of 3½" cast-iron pipe to BS 416
- Spigot end of 4" Connector incorporates gasket for direct insertion into plain end of 4" pipe e.g. cast-iron, plastic or clay

Material: Polypropylene

Nominal Size (inch)	Part Number	Colour Option	Dimensions (mm)		
			A	B	C
4"	WC144W	○	73	52	67

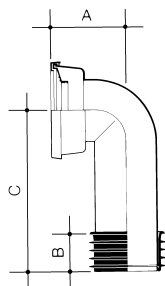

### Easy-Fit Connector – 90°

- Converts a horizontal WC outlet to a left or right-hand 'S' or 'P' trap
- Can be cut to required length
- Spigot end incorporates gasket for direct insertion into plain end of 4" pipe e.g. cast-iron, plastic or clay

Material: Polypropylene

Nominal Size (inch)	Part Number	Colour Option	Dimensions (mm)		
			A	B	C
4"	WC904W	○	107	52	236

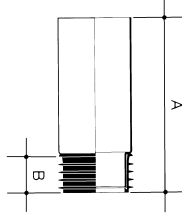

#### Straight Extension Piece

- One plain end
- Makes up the distance between any Easy-Fit Connector and soil or drain pipe connection
- Spigot end incorporates gasket for direct insertion into plain end of 4" pipe e.g. cast-iron, plastic or clay

Material: Polypropylene

Nominal Size (inch)	Part Number	Colour Option	Dimensions (mm)	
			A	B
4"	WC404W	○	255	52

# Accessories

## Osma Compact

### Air Admittance Valves

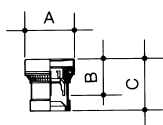

#### Air Admittance Valve

- A1 rated to BS EN 12380
- For direct connection to a 32mm [1¼"] or 40mm [1½"] waste spigot
- Allows air into discharge pipe systems without allowing foul air to escape
- BBA certificated (Certificate No. 86/1643)

Material: ABS

Nominal Size (mm)	Part Number	Colour Option	Dimensions (mm)		
			A	B	C
32/40	4S303W		66	40	71

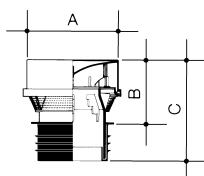

#### Air Admittance Valve

- A1 rated to BS EN 12380
- For direct connection to a 110mm spigot on BS EN 1329/BS EN 1453 soil pipe
- For 82mm pipe, the rubber seal is removed, a short length of pipe welded to the socket, and the pipe fitted into a Socket 3CS124
- Allows air into discharge pipe systems without allowing foul air to escape
- BBA certificated (Certificate No. 86/1643)

Material: ABS

Nominal Size (mm)	Part Number	Colour Option	Dimensions (mm)		
			A	B	C
110	4S304W		130	85	135

### Pipe Flashings

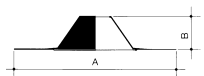

#### Varipitch Pipe Flashing for Flat Roofs

- For use with 82mm and 110mm soil pipe to BS EN 1329 which penetrates a flat roof

Material: Aluminium base, EPDM Rubber cone

Nominal Size (mm)	Part Number	Colour Option	Dimensions (mm)	
			A	B
–	4S281G		400x400	85

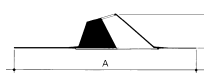

#### Varipitch Pipe Flashing for Pitched Roofs

- For use with 82mm and 110mm soil pipe to BS 1329 which penetrates a pitched roof

Material: Aluminium base, EPDM Rubber cone

Nominal Size (mm)	Part Number	Colour Option	Dimensions (mm)	
			A	B
–	4S283G		450x450	85



## Internal Drain Connector

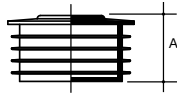

### Internal Drain Connector

- For 32mm/40mm waste pipe and 50mm waste pipe

Material: Neoprene synthetic rubber

Nominal Size (mm)	Part Number	Colour Option	Dimensions (mm) A
110x32/40	4S298	●	60.5
110x50	4S299	●	60.5

## Fire Stop Seal

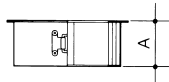

### Fire Stop Seal

- For use with 50mm, 82mm, 110mm and 160mm pipes which penetrate a compartment wall or floor
- See design and installation guidance and Building Regulations 1992, Approved Document B for fire stopping requirements

Material: Metal, containing an intumescent compound

Nominal Size (mm)	Part Number	Colour Option	Dimensions (mm) A
50	2S001	●	60
82	3S001	●	60
110	4S001	●	60

## Connectors

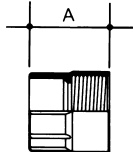

### Female Iron Connector

- Threaded socket connector, and solvent weld socket
- Threaded socket connects to 1¼", 1½" or 2" BSPT male iron spigot
- Solvent weld socket connects to 32mm [1¼"], 40mm [1½"], or 50mm [2"] plastic waste pipe to BS EN 1455-1 and BS EN 1566-1

Material: ABS

Nominal Size (mm)	Part Number	Colour Option	Dimensions (mm) A
32	4Z127W	○	50
40	5Z127W	○	53
50	2Z127W	○	60

# Accessories

## Osma Compact

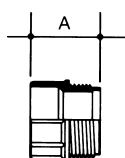

### Male Iron Connector

- Threaded spigot connector, and solvent weld socket
- Threaded spigot connects to 1¼", 1½" or 2" BSPT female iron sockets
- Solvent weld socket connects to 32mm [1¼"], 40mm [1½"], or 50mm [2"] plastic waste pipe to BS 5255

Material: ABS

Nominal Size (mm)	Part Number	Colour Option	Dimensions (mm) A
32	4Z128W ♡	○	44
40	5Z128W ♡	○	47
50	2Z128W ♡	○	53

## Spares



### Snap Cap

- Snap-on cap which retains the sealing ring in all standard Osma ring-seal fittings

Material: Polypropylene

Nominal Size (mm)	Part Number	Colour Option
82	3S116G	●



### T' Ring Seal

- Synthetic rubber sealing ring for all standard Osma ring-seal fittings

Material: EPDM

Nominal Size (mm)	Part Number	Colour Option
82	3S130G	●

## Cleaners, Solvent Cements, Lubricants



### Degreasing Cleaner No. 1

- Use for cleaning solvent weld joints prior to assembly.

Size (ml)	Part Number
250	4S380G



### Solvent Cement No. 2

- Use for making solvent weld joints

Size (ml)	Part Number
250	4S384G ♡
500	4S385G ♡



### Silicone Lubricant

- Use to aid assembly of ring-seal socket-and-spigot joints

Size	Part Number
50g tube	4S391G
400ml spray can	4S392

# Traps Osma Compact

## HepvO Hygienic Self-Sealing Waste Valve

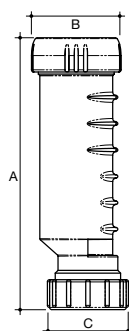

### HepvO Valve

Material: Polypropylene

Nominal Size (mm)	Part Number	Colour Option	Dimensions (mm)		
			A	B	C
32	BV1 ♡	○	188	61	55
40	CV1 ♡	○	188	68	62

## HepvO Knuckle Adaptor

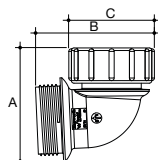

### HepvO 87.5° Knuckle Adaptor

Material: Polypropylene

Nominal Size (mm)	Part Number	Colour Option	Dimensions (mm)		
			A	B	C
32	BV11 ♡	○	66	70	50
40	CV11 ♡	○	70	74	56

## HepvO Running Adaptor

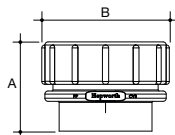

### HepvO Running Adaptor

- For installing HepvO in a pipe run

Material: Polypropylene

Nominal Size (mm)	Part Number	Colour Option	Dimensions (mm)	
			A	B
32	BV3 ♡	○	43	55
40	CV3 ♡	○	43	62

## HepvO Tundish Adaptor

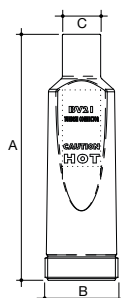

### HepvO Tundish Adaptor Kit

Material: Polypropylene

Nominal Size (mm)	Part Number	Colour Option	Dimensions (mm)		
			A	B	C
32	BV1/21 ♡	○	142	22	15

For installation tips see:



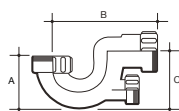

#### Tubular 'P' Outlet

- Fixed 19mm shallow seal

Material: Polypropylene

Nominal Size (mm)	Part Number	Colour Option	Dimensions (mm)		
			A	B	C
32	4V806W	○	64	139	73
40	5V806W	○	76	146	77

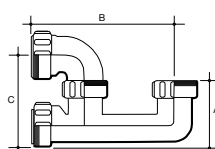

#### Tubular 'P' Outlet

- Lowline bath 50mm seal

Material: Polypropylene

Nominal Size (mm)	Part Number	Colour Option	Dimensions (mm)		
			A	B	C
40	5V802W	○	79	164	111

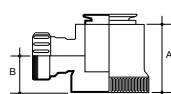

#### Bottle 'P' Outlet

- Top entry shower
- Chrome waste 50mm seal

Material: Polypropylene

Nominal Size (mm)	Part Number	Colour Option	Dimensions (mm)	
			A	B
40	5V824W	○	87	44

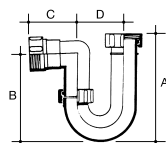

#### Tubular 'P' Outlet

- Swivel, 76mm seal

Material: Polypropylene

Nominal Size (mm)	Part Number	Colour Option	Dimensions (mm)			
			A	B	C	D
32	4V801W ♡	○	153	136	62	87
40	5V801W ♡	○	163	148	72	87

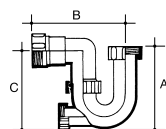

#### Tubular 'P' Outlet

- Swivel, 76mm seal c/w cleaning eye

Material: Polypropylene

Nominal Size (mm)	Part Number	Colour Option	Dimensions (mm)		
			A	B	C
40	5V846W ♡	○	163	163	116

# Traps

## Osma Compact

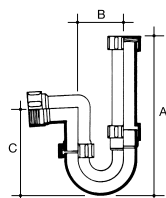

### Adjustable Tubular 'P' Outlet

- Swivel, 76mm seal telescopic maximum 40mm extension

Material: Polypropylene

Nominal Size (mm)	Part Number	Colour Option	Dimensions (mm)			
			A (min)	A (max)	B	C
40	5V807W	○	247	287	90	150

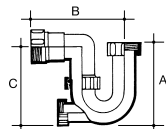

### Tubular 'Running'

- Swivel, 76mm seal

Material: Polypropylene

Nominal Size (mm)	Part Number	Colour Option	Dimensions (mm)			
			A (inlet)	B	C (outlet)	D
40	5V805W	○	160	86	149	216
50	2V805W	○	159	75	169	242

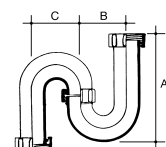

### Tubular 'S' Outlet

- Swivel, 76mm seal

Material: Polypropylene

Nominal Size (mm)	Part Number	Colour Option	Dimensions (mm)		
			A (inlet)	B	C (outlet)
32	4V803W	○	152	85	86
40	5V803W	○	162	85	85

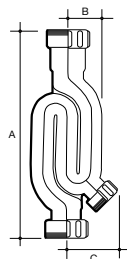

### Pedestal Trap

- Fixed, 76mm seal

Material: Polypropylene

Nominal Size (mm)	Part Number	Colour Option	Dimensions (mm)		
			A	B	C
32	4V825W	○	237	44	71

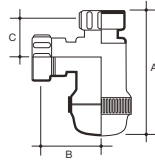

#### Bottle 'P' Outlet

- 38mm seal

Material: Polypropylene

Nominal Size (mm)	Part Number	Colour Option	Dimensions (mm)		
			A	B	C
32	4V809W	○	140	77	55
40	5V809W	○	142	84	54

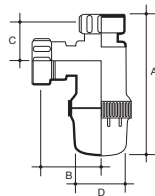

#### Bottle 'P' Outlet

- 76mm seal

Material: Polypropylene

Nominal Size (mm)	Part Number	Colour Option	Dimensions (mm)			
			A	B	C	D
32	4V812W	○	167	69	50	72
40	5V812W	○	172	76	53	79

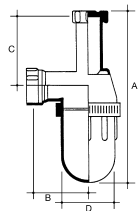

#### Bottle 'P' Outlet

- 38mm seal

Material: Polypropylene

Nominal Size (mm)	Part Number	Colour Option	Dimensions (mm)				
			A (min)	A (max)	B	C	D
40	5V808W	○	191	297	87	75	84

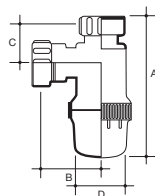

#### Bottle 'P' Anti-Syphon

- 76mm seal

Material: Polypropylene

Nominal Size (mm)	Part Number	Colour Option	Dimensions (mm)			
			A	B	C	D
32	4V814W	○	167	69	50	72
40	5V814W	○	171	82	53	79



# Traps

## Osma Compact

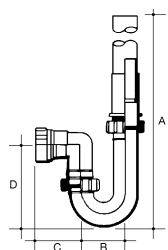
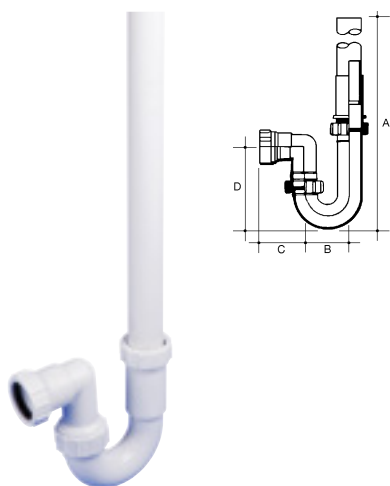

### Washing Machine Trap Kit

- 76mm seal, complete with 0.6m pipe

Material: Polypropylene

Nominal Size (mm)	Part Number	Colour Option	Dimensions (mm)			
			A	B	C	D
40	5V870W	○	678	90	72	150

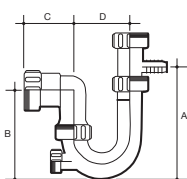

### Washing Machine Half Trap

- Swivel 76mm seal

Material: Polypropylene

Nominal Size (mm)	Part Number	Colour Option	Dimensions (mm)			
			A	B	C	D
40	5V864W	○	182	150	70	93

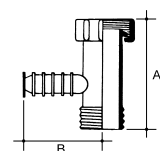

### Washing Machine Tee

Material: Polypropylene

Nominal Size (mm)	Part Number	Colour Option	Dimensions (mm)	
			A	B
40	5V871W	○	73	58

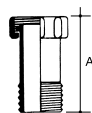

### Cap and Lining

- BSP Male Iron Tail
- 32mm Unequal Ends, 1¼ - 32mm to 1½ - 40mm
- 40mm Unequal Ends, 1½ - 40mm to 1¼ - 32mm

Material: Polypropylene

Nominal Size (mm)	Part Number	Colour Option	Dimensions (mm)
			A
32	4Z363W	○	73
40	5Z363W	○	73

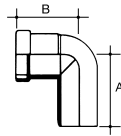

### Spigot Bend – 87.5°

- Varifix 'P' to 'S' Conversion Bend

Material: Polypropylene

Nominal Size (mm)	Part Number	Colour Option	Dimensions (mm)	
			A	B
32	4A830W	○	73	68
40	5A830W	○	73	58

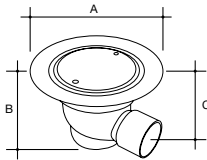

### Shower Gully

- Sheet floor

Material: ABS

Nominal Size (mm)	Part Number	Colour Option	Dimensions (mm)		
			A	B	C
50	2V510W	●	242	183	120

# Overflow Osma Compact

## Pipe



### Plain-Ended Pipe

Material: PVC-U

Nominal Size (mm)	Part Number	Colour Option	Length (m)
21.5	1E073W	○	3

## Pipe Clip

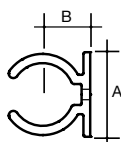

### Pipe Clip

- For support centres, see page 7

Material: PVC-U

Nominal Size (mm)	Part Number	Colour Option	Dimensions (mm)	
			A	B
21.5	1E082W	○	28	16

## Socket

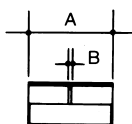

### Double Socket

- For support centres, see page 7

Material: ABS

Nominal Size (mm)	Part Number	Colour Option	Dimensions (mm)	
			A	B
21.5	1E104W	○	53	2

## Bends

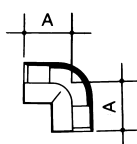

### Bend – 90°

Material: ABS

Nominal Size (mm)	Part Number	Colour Option	Dimensions (mm)
			A
21.5	1E160W	○	39

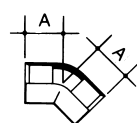

### Bend – 45°

Material: ABS

Nominal Size (mm)	Part Number	Colour Option	Dimensions (mm)
			A
21.5	1E166W	○	33

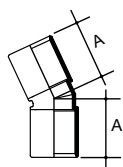

#### Bend – 25°

Material: ABS

Nominal Size (mm)	Part Number	Colour Option	Dimensions (mm)
21.5	1E163W	○	A

34

## Tee

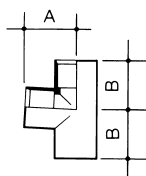

#### Tee – 90°

Material: ABS

Nominal Size (mm)	Part Number	Colour Option	Dimensions (mm)
21.5	1E190W	○	A B

39 39

## Tank Connectors

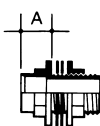

#### Straight Tank Connector

- Flanged, threaded connector at one end, 19mm solvent weld socket at the other
- Includes two gaskets for connecting to tanks or cisterns

Material: ABS

Nominal Size (mm)	Part Number	Colour Option	Dimensions (mm)
21.5	1E129W	○	A

27

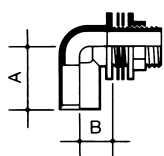

#### Bent Tank Connector – 90°

- Flanged, threaded connector at one end, 19mm solvent weld socket at the other
- Includes two gaskets for connecting to tanks or cisterns

Material: ABS

Nominal Size (mm)	Part Number	Colour Option	Dimensions (mm)
21.5	1E139W	○	A B

45 42

# Overflow Osma Compact

## Reducers

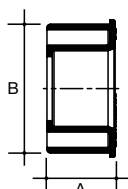

### Waste to Overflow Reducer

- Fits inside a solvent weld waste socket to BS EN 1455-1 and BS EN 1566-1
- Allows connection of 21.5mm pipe

Material: ABS

Nominal Size (mm)	Part Number	Colour Option	Dimensions (mm)	
			A	B
32x21.5	1E344W	○	19	36
40x21.5	1E346W	○	23	43

## Cap and Lining

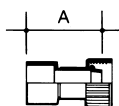

### Cap and Lining

- Threaded nut connector at one end, 21.5mm solvent weld socket at the other
- The nut connects to 3/4" BSPT male thread

Material: ABS

Nominal Size (mm)	Part Number	Colour Option	Dimensions (mm)	
			A	
21.5	1E156W	○	54	

## Tundish

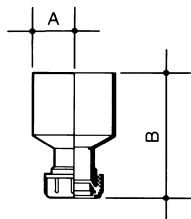

### Tundish

- Provides an air break

Material: Polypropylene

Nominal Size (mm)	Part Number	Colour Option	Dimensions (mm)	
			A	B
21.5	1O149W	○	28	88

## Soakaway

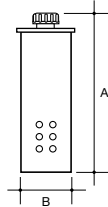

### Soakaway

- 110mm OD with 21.5mm, 32mm, 40mm pipe connections

Material: Polypropylene

Nominal Size (mm)	Part Number	Colour Option	Dimensions (mm)	
			A	B
110	1V403G	●	325	120

## Connectors and Adaptors

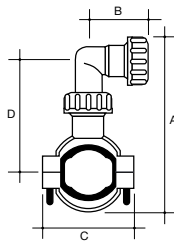

### Pipe Clamp

- 32/40mm waste and 21.5mm connection

Material: Polypropylene

Nominal Size (mm)	Part Number	Colour Option	Dimensions (mm)			
			A	B	C	D
21.5	1V402W	○	130	48	71	78

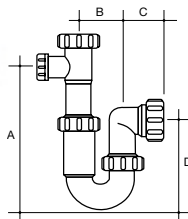

### Tubular Swivel Trap

- 40mm x 75mm adjustable with 21.5mm connection

Material: Polypropylene

Nominal Size (mm)	Part Number	Colour Option	Dimensions (mm)			
			A	B	C	D
40	5V407W	○	224	63	68	130

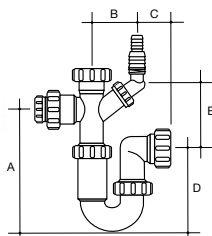

### Tubular Swivel Trap

- 40mm x 75mm adjustable with 21.5mm connection and washing machine nozzle

Material: Polypropylene

Nominal Size (mm)	Part Number	Colour Option	Dimensions (mm)				
			A	B	C	D	E
40	5V468W	○	188	130	61	130	90

# Design Information

## Osma Compact

### Typical Bathroom Installation

The diagrams below show a typical bathroom installation using Osma PVC-U Compact Soil.

Osma PVC-U Compact Soil fittings are specifically designed to minimise installed space requirement. The 32mm and 40mm 90° Boss Adaptors can locate and be adjusted within a 200mm cast hole.

#### Elevation

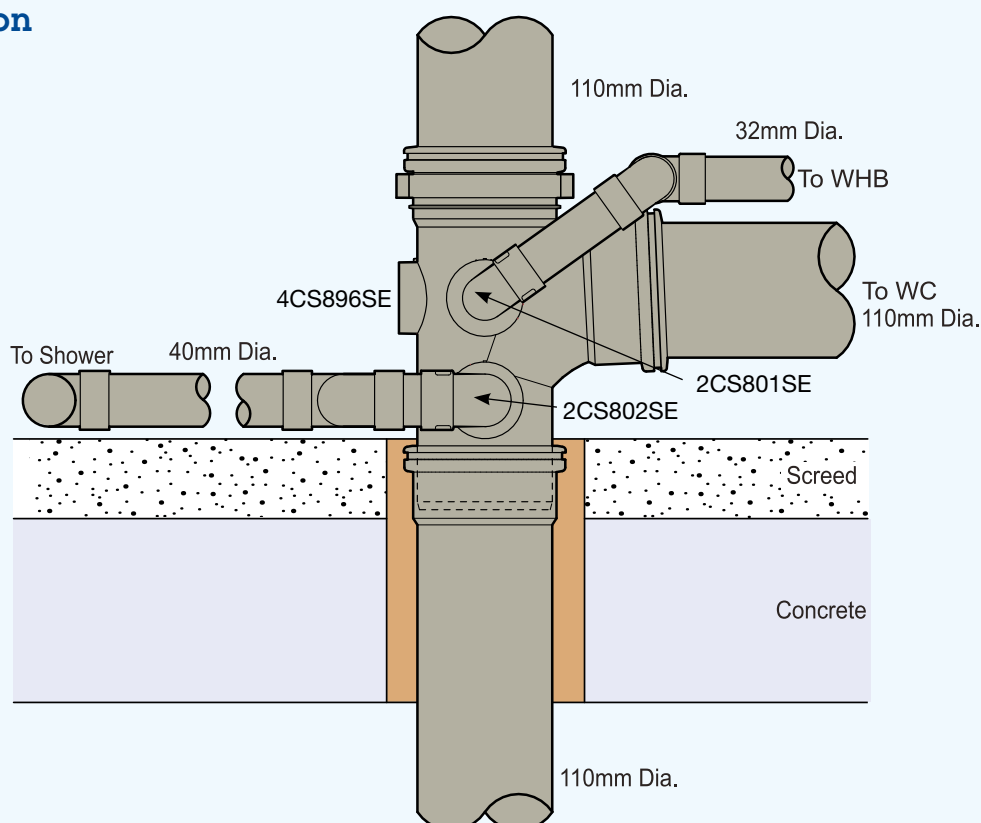

#### Plan

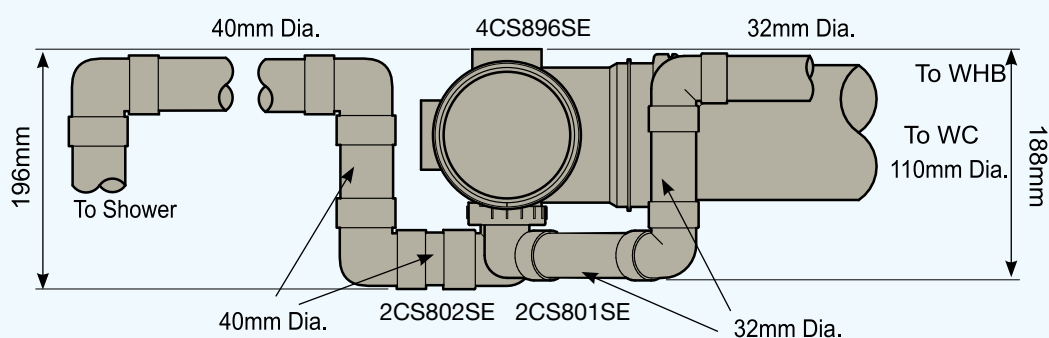



# Transport, Handling and Storage

## Osma Compact

### Handling, Storage and Safety

#### Handling

Care should be taken when handling pipe and fittings. Excessive scratching or scoring harms the appearance and can also affect the joint sealing.

Take extra care when handling pipe and fittings in wintry conditions. Cold weather reduces the impact strength of plastics. Use nylon belt slings, or forklifts with smooth forks, for mechanical unloading of block bundles. Metal slings, hooks or chains must not come into contact with pipes (see Figure 1).

Load and unload loose pipe by hand. Avoid using skids. When loose pipes have been transported one inside the other, always remove the inner pipe first.

Figure 1: Unloading of block bundles

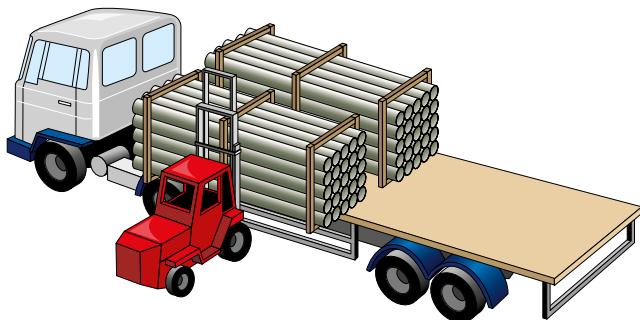

#### Storage

Always store pipe on a reasonably flat surface free from sharp projections.

#### Block bundles

Block bundles can be stored up to 3m high without extra side supports or bearers. Block bundles will remain free-standing when cut. Take care when releasing bundles as the straps are under considerable tension and may flail when cut.

#### Loose pipes

Loose pipe requires side supports at least every 2m. These supports should consist of battens at least 75mm wide. Ideally, support loose gutter or pipe uniformly throughout its entire length. If this is not possible, place timber supports at least 75mm wide at 1m maximum centres beneath the pipe (see Figure 3) Stack different size pipe separately, or, if not possible, stack with larger diameters at the bottom.

Maximum stack size: 7 layers or 2m high (see Figure 2).

Stack Socketed Pipe with sockets protruding and placed at alternate ends to ensure pipe is evenly supported.

#### Fittings

Store fittings supplied in plastic bags away from direct sunlight. If this is not possible, open bags to prevent a build-up of temperature.

Fittings in cardboard packaging (e.g. Fire Stop Seals and Air Admittance Valves) should be stored under cover until required.

Store degreasing cleaners, silicone lubricant, solvent cement and fillers in a cool place away from any heat source and out of direct sunlight.

#### Safety

The relevant regulations detailed in the Health and Safety at Work Act 1974 must be adhered to on site.

Figure 2: Storage of loose pipe on the ground

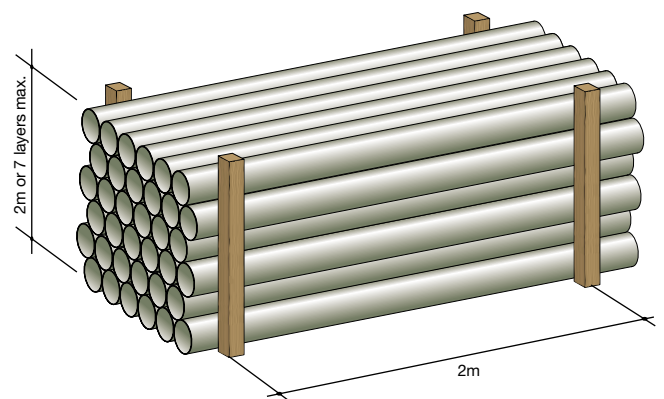
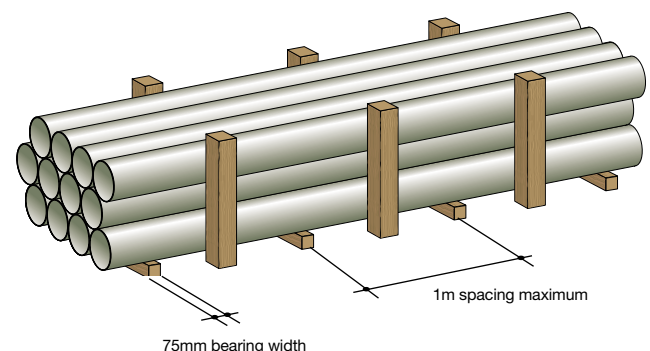

Figure 3: Storage of loose pipe on bearers



# General Information

## Osma Compact

### Materials

Pipes and most fittings in Osma Soil and Waste systems are manufactured from the following materials, as individually denoted in the product listings in this Guide.

Material	Systems
PVC-U Unplasticised Polyvinyl Chloride	Soil systems and Solvent Weld Overflow system (pipe only)
PP Polypropylene	Push-Fit Waste system and Push-Fit Overflow system
ABS Acrylonitrile Butadiene Styrene	ABS Solvent Weld Waste system and Solvent Weld Overflow system (fittings only)
PVC-C Chlorinated poly (vinyl chloride) (PVC-C)	PVC-C Solvent Weld Waste System
PE Polyethylene	V-Joint Traps

### Quality, Standards and Approvals

The British Standards Institution has issued certificates registering Wavin as a firm of assessed capability, with a quality management system which meets the requirements of BS EN ISO 9001.

Wavin systems are the benchmark for excellence and product innovation: precision-manufactured using the most advanced injection moulding and extrusion machines. All products comply with or exceed relevant British and European standards to ensure reliability and long-lasting service.

### Acceptance

Osma Soil and Waste systems comply, where applicable, with the requirements of the following British Standards:

- BS 3943:1983 Specification for waste traps
- BS 4514:2001 Unplasticised PVC soil and ventilating pipes, fittings and accessories (82.4mm minimum mean outside diameter)

- BS 6209:1982 Solvent cement for non pressure thermoplastics pipe systems
- BS EN 1329-1:2000 Plastics piping systems for soil and waste discharge (low and high temperature) within the building structure. PVC-U
- BS EN 1453-1:2000 Plastics piping systems with structured-wall pipes for soil and waste discharge (low and high temperature) inside buildings. Unplasticized poly (vinyl chloride) (PVC-U)
- BS EN 1566-1:2000 Plastics piping systems for soil and waste discharge (low and high temperature) within the building structure. PVC-C Chlorinated poly (vinyl chloride)
- BS EN 12380:2002 Air admittance valves for drainage systems



The British Standard Kitemark identifies pipe and fittings that are manufactured under the BSI certification scheme.



Osma Soil systems have been awarded British Board of Agrément [BBA] certification as follows:

- Air Admittance Valve 40 and Air Admittance Valve 110 (page 40) – 86/1643
- 110mm Adjustable Bends (page 25) – 89/2174

### References

Osma Soil and Waste systems should be designed and installed in accordance with the guidance provided in the appropriate sections of the following:

- Building Regulations 2000 (England and Wales): Approved Document H, Part H1
- Building Standards (Scotland) Regulations 1993-2002 (including current amendments: Technical Standards Part M)
- Building Regulations (Northern Ireland) 2000: Technical Booklet N
- BS 8000 Workmanship on Building Sites: Part 13: 1989 Code of Practice for above ground drainage and sanitary appliances
- BS EN 12056: 2000 Gravity drainage systems inside buildings: Part 3 Roof drainage, layout and calculation
- Painting plastics: IP 11/1979. Watford, BRE 1979
- Water Regulations Guide: London, Water Regulations Advisory Scheme, 2000
- BS EN 752:2008 – Drain and sewer systems outside buildings
- Osma Soil and Waste Product and Installation Manual

## Environment

All Wavin manufacturing sites operate Environmental Management Systems which comply with the requirements of and are certified to ISO 14001: 2004.

## Health and Safety

The relevant provisions of the following legislation should be adhered to on site:

- ④ Construction (Design and Management) Regulations 1994
- ④ Control of Substances Hazardous to Health Regulations 1988
- ④ Health and Safety at Work Act 1974
- ④ Management of Health and Safety at Work Regulations 1999
- ④ Manual Handling Operations Regulations 1992

## Hazards associated with PVC-U, PVC-C, Polypropylene and Polyethylene

There are no particular hazards associated with handling, cutting or working with the materials mentioned above, and protective clothing or equipment is not normally required.

Safety Data Sheets covering PVC-U, PVC-C, PP, PE, lubricant, solvent cements and cleaners are available from the Wavin Technical Design Department, please call Technical Enquiries to obtain a copy.

## Abbreviations

Key	
P/E:	Pipe and fittings with both ends plain or with one plain end and one special end
S/S:	Pipe and fittings with one or more ring-seal or push-fit sockets, but always one plain or special end
D/S:	Fittings with ring-seal or push-fit sockets at all ends
S/SW:	Fittings with one or more ring-seal sockets but always one solvent socket
SW/S:	Fittings with one or more solvent sockets and one plain or special end
D/SW	Fittings with solvent sockets at all ends

## Supply

All systems are supplied through a nationwide network of merchant distributors. For details of your nearest merchant, contact Wavin Customer Services.

## Sealing Rings

Where applicable, Sealing Rings are supplied fitted to each component and are included in the price.

## Conditions of Sale

Wavin will not accept responsibility for the malfunction of any installation which includes components not supplied by Wavin. Goods are sold subject to Company conditions of sale.

## Other Wavin Industrial and Commercial Systems

### Tigris K1 Multilayer Press-fit System

High efficiency supply system for potable water, sanitary and heating applications.

- ④ Efficient installation, superlative performance
- ④ Advanced performance Hot & Cold plumbing system designed for potable, sanitary and heating applications in industrial, commercial and other large buildings
- ④ Fully-proven in Europe for over 10 years and now available for selection by specifiers and installers in the UK

### Wavin AS Acoustic Soil System

A technologically advanced, push-fit soil system that delivers significant noise reduction over standard soil systems. The Astolan® material can absorb both structural and airborne sound.

- ④ Extremely lightweight, robust and corrosion-resistant
- ④ Fast and easy installation, saving time and cost – especially compared with cast iron alternative
- ④ Complies with Building Regulations, Part E
- ④ Wrapping of pipe not necessary to achieve noise reduction

### Wavin HDPE Soil and Waste System

Wavin HDPE is a complete soil, waste and vent system of pipes and fittings, manufactured from high-density polyethylene and is suitable for a range of domestic and commercial applications.

- ④ Available in sizes from 40-315mm
- ④ Wavin HDPE is resistant to temperatures of up to 100°C
- ④ Wavin HDPE is well suited to assemblies subjected to vibration. It is therefore ideal for use in seismic zones and across expansion joints
- ④ Available in Wavin's Revit software for BIM

# General Information

## Osma Compact

### Technical Advice

Osma Compact Soil is backed by Wavin's comprehensive technical advice service. This is available to provide expert assistance at every stage of a project, from planning and product selection to installation and maintenance.

Contact Wavin Technical Design Department:

Tel: 0844 856 5165

Email: [technical.design@wavin.co.uk](mailto:technical.design@wavin.co.uk) or via online enquiry at [wavin.co.uk](http://wavin.co.uk)

### Literature

The following Wavin publications are also available from the Literature Department at Chippenham.

#### General

- Wavin Above Ground Systems: Trade Price List

#### Above Ground Systems

- Osma Soil and Waste:  
Product and Installation Manual
- Tigris K1:  
Product and Installation Manual
- Hep<sub>2</sub>O:  
Product Guide
- Wavin HDPE:  
Product and Installation Manual
- Wavin AS Acoustic Soil:  
Product and Installation Manual

To request details with regards to any of the above components and/or for any technical enquires please contact:

#### Literature Request

Tel: 01249 766333

Email: [literature@wavin.co.uk](mailto:literature@wavin.co.uk)

#### Technical Design

Tel: 0844 856 5165

Email: [technical.design@wavin.co.uk](mailto:technical.design@wavin.co.uk)

#### Wavin Online

The complete range of Wavin/Osma product and installation guides are also available online at: [wavin.co.uk](http://wavin.co.uk)

Did you know you can also download our BIM files, take e-learning courses and CPD's online at [myportal.wavin.co.uk](http://myportal.wavin.co.uk) and you can see installation tips on our YouTube channel WavinUK



# Notes

# Osma Compact

# Notes

# Osma Compact

Discover our broad portfolio at  
**[www.wavin.co.uk](http://www.wavin.co.uk)**



Water management | Plumbing and heating | **Waste water drainage**  
Water and gas distribution | Cable ducting

**Mexichem.**  
Building & Infrastructure



**CONNECT TO BETTER**

**Wavin Limited**  
Registered Office  
Edlington Lane  
Doncaster | DN12 1BY  
Tel. 0844 856 5152  
[www.wavin.co.uk](http://www.wavin.co.uk) | [info@wavin.co.uk](mailto:info@wavin.co.uk)

© 2017 Wavin Limited

Wavin operates a programme of continuous product development, and therefore reserves the right to modify or amend the specification of their products without notice. All information in this publication is given in good faith, and believed to be correct at the time of going to press. However, no responsibility can be accepted for any errors, omissions or incorrect assumptions. Users should satisfy themselves that products are suitable for the purpose and application intended.

For further product information visit: [wavin.co.uk](http://wavin.co.uk)

